

ARCHITECT'S SUPPLEMENTAL INSTRUCTIONS

ESKEW+DUMEZ+RIPPLE, APC

Owner	[X]
Architect	[X]
Contractor	[X]
Consultant	[]
Other	[]

ARCHITECT'S SUPPLEMENTAL INSTRUCTION NO: 024**DATE OF ISSUANCE: 10/15/21**

Project: LYCEE FRANCAIS DE LA NOUVELLE-ORLEANS (LFNO)
1619 LEONIDAS STREET
NEW ORLEANS, LA 70118

Architect: ESKEW+DUMEZ+RIPPLE, APC
365 CANAL STREET, SUITE 3150
NEW ORLEANS, LA 70130

Owner: 1601 LEONIDAS, LLC
5951 PATTON STREET
NEW ORLEANS, LA 70115

ARCHITECT'S PROJECT NO. 15101

CONTRACT FOR: GENERAL CONSTRUCTION

To: DONAHUEFAVRET CONTRACTORS, INC.
3030 EAST CAUSEWAY APPROACH
MANDEVILLE, LA 70448

CONTRACT DATED: JULY 1, 2020

The Work shall be carried out in accordance with the following supplemental instructions issued in accordance with the Contract Documents without increase in Contract Sum or Contract Time. Proceeding with the Work in accordance with these instructions indicates your acknowledgment that there will be no increase in the Contract Sum or Contract Time.

Description:

See descriptions of work on next pages. See diagram on second page for locations of work.

Attachments:

ASI #024 Sketches dated 10.15.2021

ISSUED BY: Andy Redmon



Photo 1

Remove plywood and window. See Photo 3 notes for stud infill at the office side. Create inset gyp-board "nook" with ledge at the corridor side where window/plywood was removed. Prep and paint same wall color indicated for this corridor.



Photo 2

Remove plaster on corridor side of this portion of wall. Remove all wood studs and clean cavity. Infill with 3-5/8" metal studs with one layer of gyp from brick-to-brick jambs. Prep and paint same wall color indicated for this corridor.



Photo 3

Install hat channel and one layer of gyp board on existing masonry. Prep and paint same color as walls indicated for this corridor.

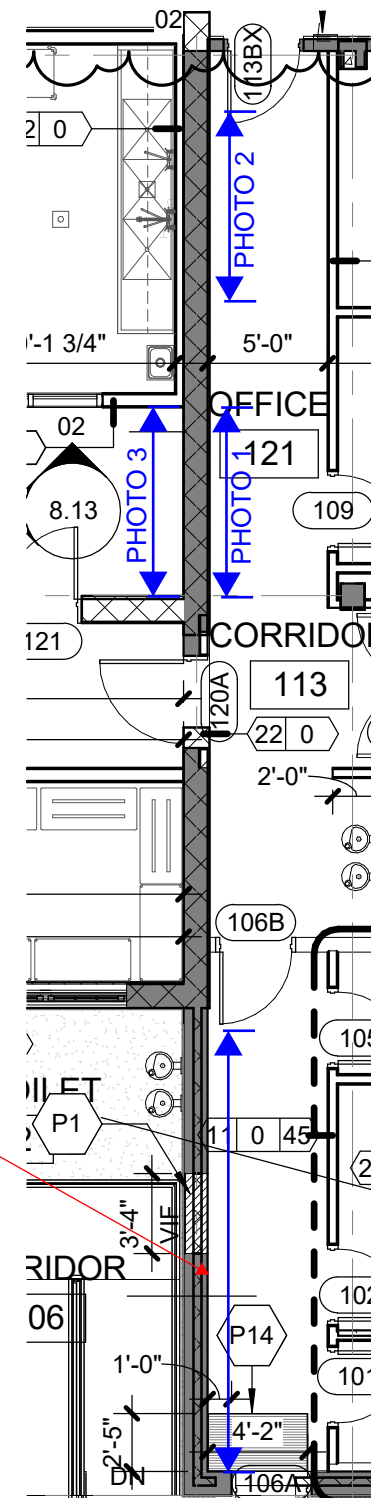



3030 East Causeway Approach
Mandeville, LA 70448
985 626.4431
Fax 985 626.3572
donahuefavret.com

November 2, 2021

Mr. John Vollman
CM Task Force
5951 Patton Street
New Orleans, LA 70115

RE: Lycee Francais Renovation
1601 Leonidas Street
New Orleans, LA 70118
Proposal # 057

This proposal request includes all labor, material, tax, insurance, supervision and equipment necessary for the work listed in ASI 024 dated 10/15/2021.

For a total cost of	<u>\$4,441</u>
Add days	<u>0</u>

We reserve the right to revise this proposal if not accepted within 15 days from this date. Please note that the general conditions will be revised based up the approval date.

If you have any questions, please feel free to contact our office.

Sincerely,
DonahueFavret Contractors, Inc.

A handwritten signature in blue ink, appearing to read 'Bill Mardis', is written over the company name.

Bill Mardis
Senior Project Manager

cc: File; Field

Accepted By:

_____ Date:_____

DonahueFavret Contractors, Inc.
Cost Proposal Request

Project	Lycee Francais Renovation	PR#	57
Location	1601 Leonidas Street, New Orleans, LA 70118	Date	11/2/2021
Architect	Eskew+Dumez+Ripple, APC	Owner	1601 Leonidas, LLC
		Checked By	BM

Description of Services:

This proposal request includes all labor, material, tax, insurance, supervision and equipment necessary for the work listed in ASI 024 dated 10/15/2021.

DESCRIPTION	QUANTITY	UNIT	LABOR		MATERIAL		SUB / OTHER	
			UNIT	TOTAL	UNIT	TOTAL	UNIT	TOTAL
				\$0		\$0		\$0
South Work Contractors	1	LS		\$0		\$0	4028	\$4,028
				\$0		\$0		\$0
				\$0		\$0		\$0
				\$0		\$0		\$0
				\$0		\$0		\$0
				\$0		\$0		\$0
				\$0		\$0		\$0
				\$0		\$0		\$0
				\$0		\$0		\$0
				\$0		\$0		\$0
				\$0		\$0		\$0
				\$0		\$0		\$0
				\$0		\$0		\$0
				\$0		\$0		\$0
				\$0		\$0		\$0
				\$0		\$0		\$0
				\$0		\$0		\$0
				\$0		\$0		\$0
				\$0		\$0		\$0
				\$0		\$0		\$0
				\$0		\$0		\$0
				\$0		\$0		\$0
				\$0		\$0		\$0
				\$0		\$0		\$0
SUB TOTALS:				\$0		\$0		\$4,028
SUB TOTALS WITH LABOR BURDEN & TAX:			45%	\$0	9.45%	\$0		\$4,028

Days ADDED to Contract:	0
Days price is good for:	5

TOTAL COST OF WORK:		\$4,028
DFC OH&P - DFC Labor & Materials	10%	\$0
DFC OH&P - Subcontractors	5%	\$201
SUB TOTAL:		\$4,229
SAFETY:	1%	\$42
INSURANCE:	2%	\$85
BOND:	2%	\$85
TOTAL:		\$4,441

ARCHITECT'S SUPPLEMENTAL INSTRUCTIONS

ESKEW+DUMEZ+RIPPLE, APC

Owner	[X]
Architect	[X]
Contractor	[X]
Consultant	[]
Other	[]

ARCHITECT'S SUPPLEMENTAL INSTRUCTION NO: 024**DATE OF ISSUANCE: 10/15/21**

Project: LYCEE FRANCAIS DE LA NOUVELLE-ORLEANS (LFNO)
1619 LEONIDAS STREET
NEW ORLEANS, LA 70118

Architect: ESKEW+DUMEZ+RIPPLE, APC
365 CANAL STREET, SUITE 3150
NEW ORLEANS, LA 70130

Owner: 1601 LEONIDAS, LLC
5951 PATTON STREET
NEW ORLEANS, LA 70115

ARCHITECT'S PROJECT NO. 15101

CONTRACT FOR: GENERAL CONSTRUCTION

To: DONAHUEFAVRET CONTRACTORS, INC.
3030 EAST CAUSEWAY APPROACH
MANDEVILLE, LA 70448

CONTRACT DATED: JULY 1, 2020

The Work shall be carried out in accordance with the following supplemental instructions issued in accordance with the Contract Documents without increase in Contract Sum or Contract Time. Proceeding with the Work in accordance with these instructions indicates your acknowledgment that there will be no increase in the Contract Sum or Contract Time.

Description:

See descriptions of work on next pages. See diagram on second page for locations of work.

Attachments:

ASI #024 Sketches dated 10.15.2021

ISSUED BY: Andy Redmon



Photo 1

Remove plywood and window. See Photo 3 notes for stud infill at the office side. Create inset gyp-board "nook" with ledge at the corridor side where window/plywood was removed. Prep and paint same wall color indicated for this corridor.



Photo 2

Remove plaster on corridor side of this portion of wall. Remove all wood studs and clean cavity. Infill with 3-5/8" metal studs with one layer of gyp from brick-to-brick jambs. Prep and paint same wall color indicated for this corridor.



Photo 3

Install hat channel and one layer of gyp board on existing masonry. Prep and paint same color as walls indicated for this corridor.

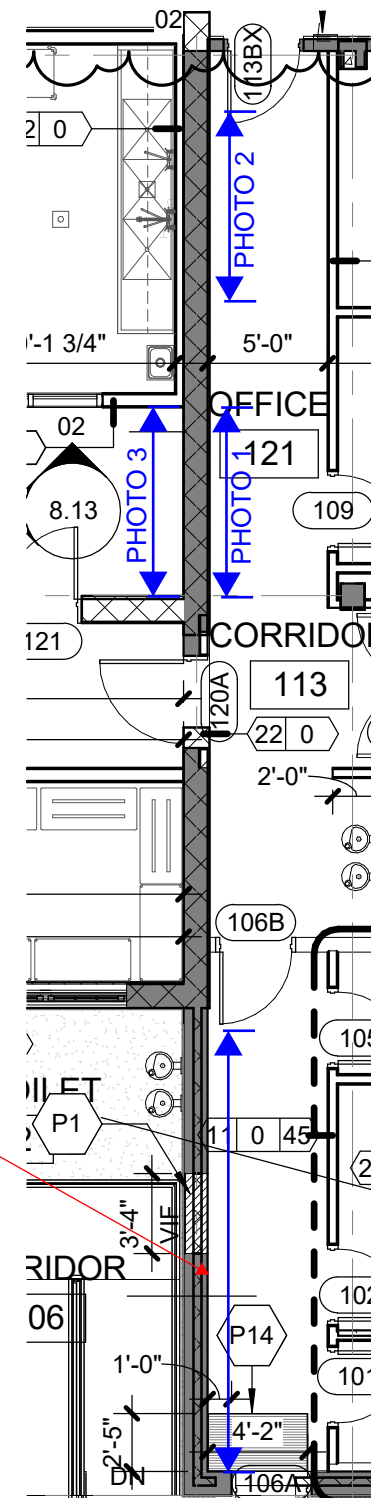

SW South Work Contractors L.L.C
3805 Florida Ave, Kenner LA 70065

Phone: 504-319-5169

Date: 10/20/2021

Change order ASI 024

Project Name: Lycée Francais Orleans Priestley School

Job Location: 1601 Leonidas St. New Orleans LA 70118

Contact Person:

Walter Arita: 504-319-5169

Email:

warita@sw.contractors

LICENCE # 68948

We propose to furnish all necessary, Material, labor, equipment, tools, Insurance and accordance with the project plans issued and the inclusions, exclusions, and general conditions shown below

C/O -----

\$4,027.72

Inclusion:

- Metal stud wall frame s
- Removing existing condition window plaster etc..
- Install hat channels
- Sheetrock finish mud
-

Exclusions:

- Dumpster,

General Conditions:

- Daily Clean-Up of our construction Debris
- Lighting & Heating by General Contractor
- Quote good only for 30
- Payment Due every 30 Days

Construction Contract Change Order 2 BREAKDOWN

Project No.: 20117-03 RFI No1. (or COR, CPR, etc.) ASI 024
 Date: 10/20/2021
 Project Name: Lycee' Francais de la nouvelle-orleans Priestley

Contractor/Subcontractor Name: South Work contractors LLC

Direct Cost of Work : Acct/Finance 148: Changed dimension of the room and added a glass slider door

A. Labor		Hourly Wage Rate	Hours	Total Cost
Check here if explained on the Comment Sheet				
1	removing and window 2 mann	<input type="checkbox"/> 25.00	5	\$125.00
2	removing plaster on the corridor	<input type="checkbox"/> 25.00	20	\$500.00
3	intall metal stud and hat channel	<input type="checkbox"/> 25.00	25	\$625.00
4	Install sheetrock all areas	<input type="checkbox"/> 25.00	25	\$625.00
5	primer and Pinting new wall GC Sele color	<input type="checkbox"/> 25.00	20	\$500.00
6	cleup	<input type="checkbox"/> 25.00	10	\$250.00
7		<input type="checkbox"/>		
		Add Labor Burden @	5 %	\$131.25
		Add Fringe @	%	
LABOR TOTAL				\$2,756.25

B. Material		Unit Price	Unit	Units	Total Cost
1	Metal stud 20 ga	<input type="checkbox"/> 20.00		10	\$200.00
2	Track runner 20 ga	<input type="checkbox"/> 10.00		6	\$60.00
3	sheetrock by sheet MR	<input type="checkbox"/> 26.00		15	\$390.00
4	Framer and sheetrock Screw corner bead	<input type="checkbox"/> 55.00		1	\$55.00
5	Bag mud and type	<input type="checkbox"/> 20.00		4	\$80.00
6	Pinting and primer	<input type="checkbox"/> 130.00		1	\$130.00
7	Hat channels on the masonry wall	<input type="checkbox"/> 15.00		18	\$270.00
(Copies of invoices may be required.)		Add Tax @	9.45 %		\$86.47
MATERIAL TOTAL					\$1,271.47

C. Credit for Portion of wall not build for grid 1th		Unit Rate	Unit	Units	Total Cost
1		<input type="checkbox"/>			
2		<input type="checkbox"/>			
3		<input type="checkbox"/>			
4		<input type="checkbox"/>			
5		<input type="checkbox"/>			
6		<input type="checkbox"/>			
7		<input type="checkbox"/>			
(Copies of invoices may be required.)		Add Tax @	%		
EQUIPMENT TOTAL					

TOTAL DIRECT COST FOR THIS BREAKDOWN:

CREDIT BACK FOR CORNER WE DON'TT FRAMER

\$4,027.72